

PLAZA EAST ADDITION AMENDED 2014 FINAL PLANNED UNIT DEVELOPMENT PLAN AND PLAT

A Planned Unit Development in the West Half of Section 26, Township 19 South, Range 3 West of the 6th P.M.,
City of McPherson, McPherson County, Kansas

Page 2 of 2

PUD RECORD BOUNDARY DESCRIPTION:

The following described tract is the description of the boundary of the Plaza East Addition based on survey on April 12, 1999 per the Amendment to Tract II as certified by Dan Garber, as filed at the Register of Deeds Plat Bk. "B", Page 60 in McPherson County, McPherson County, Kansas. The basis of origin is from Francis Rankin survey Champlin Addition 1/9/1970.

Commencing at the Southwest corner of the NW1/4 of Section Twenty-six, Township 19 South, Range Three West of the Sixth Principal Meridian, in McPherson County, Kansas, thence S89°22'43"E a distance of 976.65 feet measured (971.65 feet recorded) to the point of beginning;
thence N 00°00'00" W, 371.80' along the east right-of-way of Champlin Street;
thence N 87°13'55" E, 269.55';
thence S 85°20'59" E, 496.99';
thence S 89°19'48" E, 490.49';
thence S 19°33'59" E, 375.19';
thence N 89°22'43" W, 455.78';
thence S 00°00'00" E, 80.00';
thence S 48°17'17" W, 616.14';
thence S 90°00'00" W, 465.00';
thence N 00°00'00" W, 500.00'
to the point of beginning containing 19.38 acres more or less.
Precision: 1:17398.37

LAND SURVEYOR'S CERTIFICATE AND DESCRIPTION:

I, the undersigned registered land surveyor in the State of Kansas, do hereby certify that the following described tracts were surveyed under my direct supervision on February 20, 2014 and the accompanying Plaza East Addition Amended 2014 Planned Unit Development prepared and that all the monuments shown herein actually exist and their positions are correctly shown to the best of my knowledge and belief:

DESCRIPTION TRACT IA1:

A part of Tract IA as shown in the April 2010 Amendment to the Final P.U.D. Plan of Plaza East Addition, beginning at the Southwest Corner of Tract IA as shown in the April 2010 Amendment to Final P.U.D. Plan of Plaza East Addition as recorded in Plat Book C, Page 14 at the McPherson County Register of Deeds Office;
thence N 00°00'00" E along the west line of Tract IA, 244.89';
thence N87°13'55"E, 90.24';
thence S85°20'59"E, 41.89';
thence S00°00'00"W, 245.85';
thence N90°00'00"W, 131.89' to said point of beginning containing 0.75 acres more or less in the City of McPherson, McPherson County, Kansas.

DESCRIPTION TRACT IA2:

Commencing at the Southwest corner of TRACT IA as shown in the April 2010 Amendment to Final P.U.D. Plan of Plaza East Addition as recorded in Plat Book C, Page 14 at the McPherson County register of Deeds Office;
thence N90°00'00"E, 131.89' to the point of beginning;
thence N00°00'00"E, 245.85';
thence S85°20'59"E, 124.28' to the Northeast corner of Tract IA of said P.U.D.;
thence S04°39'01"W, 60.00'; thence S00°00'00"E, 175.97';
thence N90°00'00"W, 119.00' to said point of beginning containing 0.66 acres more or less in the City of McPherson, McPherson County, Kansas.

Melanie L. Thower

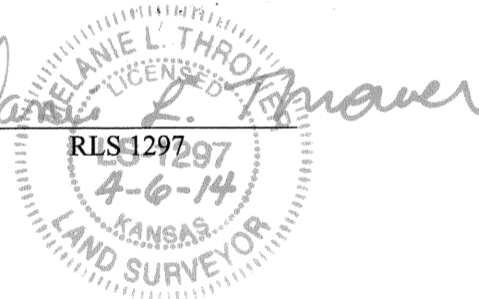

COUNTY SURVEYOR CERTIFICATE

State of Kansas)
County of McPherson)

Reviewed by the Unified Government Surveyor this 23rd day of May, 2014. This survey has been reviewed for filing, pursuant to K.S.A. 58-2005 and K.S.A. 58-2011 for content only and is in compliance with those provisions. No other warranties are extended or implied.

William B. Heller, LS #1202 McPherson County Surveyor

OWNER'S CERTIFICATE AND DEDICATION:

STATE OF KANSAS)
COUNTY OF MCPHERSON)

This is to certify that the undersigned owner(s) of the land described in the Surveyor's Certificate; have caused the same to be surveyed and subdivided on the accompanying plat into lots, blocks, streets and other public ways under the name of Plaza East Addition Amended 2014 Final Planned Unit Development Plan and Plat; that all highways, streets, alleys, easements and public grounds as denoted on the plan are hereby dedicated to and for the use of the public for the purposes of constructing, operating, maintaining and repairing public improvements; and further that the land contained herein is held and shall be conveyed subject to any applicable restrictions, reservations, and covenants now on file or hereafter filed in the Office of the Register of Deeds of McPherson County, Kansas.

Samson Pinter, Member
TRACT I, IA1 AND IA2

Larry Patel, Operating Manager
TRACT IIB and TRACT III
Comart Development, L.L.C.

NOTARY CERTIFICATES

STATE OF MISSOURI)
COUNTY OF CLAY)

The foregoing instrument was acknowledged before me this 9th day of April, 2014, by Larry Patel.

Notary Public

My commission expires: 7/15/2017

STATE OF OKLAHOMA)
COUNTY OF OKLAHOMA)

The foregoing instrument was acknowledged before me this 20th day of May, 2014, by Samson Pinter, Member, Cedar Hills Realty L.L.C.

Notary Public

My commission expires: 06-15-2017

STATE OF OKLAHOMA)
COUNTY OF TULSA)

The foregoing instrument was acknowledged before me this 6th day of May, 2014, by Jeffrey W. Davis.

Notary Public

My commission expires: 6-13-2017

STATE OF KANSAS)
COUNTY OF SEDGWICK)

The foregoing instrument was acknowledged before me this 1st day of April, 2014, by James H. Stevens and Ann M. Stevens.

Notary Public

My commission expires: 6/4/2015

MORTGAGE HOLDER

We, Home State Bank and Trust, by Ted Odle, President, holders of a mortgage on the above described property do hereby consent to the plan of Plaza East Addition, City of McPherson, McPherson County, Kansas.

Home State Bank And Trust
223 N. Main Street
McPherson, Kansas

Ted Odle, President

MORTGAGE HOLDER

We, Bank of Oklahoma, by Bryan Geiger, Senior Vice President, holders of a mortgage on the above described property do hereby consent to the plan of Plaza East Addition, City of McPherson, McPherson County, Kansas.

Bank of Oklahoma
9520 N. May Avenue
Oklahoma City, OK 73120

Bryan G. Geiger, Senior Vice President

MORTGAGE HOLDER

We, Bank of America, by Mark Heiman, Senior Vice-President, holders of a mortgage on the above described property do hereby consent to the plan of Plaza East Addition, City of McPherson, McPherson County, Kansas.

Bank of America
P.O. Box 4
Wichita, Kansas 67201

Mark Heiman, Senior Vice-President

NOTARY CERTIFICATES

STATE OF KANSAS)
COUNTY OF MCPHERSON)

The foregoing instrument was acknowledged before me this 15th day of April, 2014, by Ted Odle, President Home State Bank and Trust.

Notary Public

My commission expires: 4-25-2017

STATE OF OKLAHOMA)
COUNTY OF CUSTER)

The foregoing instrument was acknowledged before me this 7th day of May, 2014, by Bryan Geiger, Senior Vice President Bank of Oklahoma.

Notary Public

My commission expires:

STATE OF KANSAS)
COUNTY OF _____)

The foregoing instrument was acknowledged before me this _____ day of _____, 20____, by Mark Heiman, Senior Vice-President Bank of America.

Notary Public

My commission expires:

PLANNING COMMISSION CERTIFICATE

STATE OF KANSAS)
CITY OF MCPHERSON)

This plan was approved by the McPherson City Planning Commission on

April 1, 2014

Signed: May 28, 2014
Donna S. Lehner, Chairperson

ATTEST:
Gail Lauderdale, Secretary

COUNTY CLERK AND CITY CLERK CERTIFICATE

STATE OF KANSAS)
COUNTY OF MCPHERSON)
CITY OF MCPHERSON)

We, the undersigned, County Clerk of McPherson County, Kansas, and City Clerk of the City of McPherson, Kansas, within our respective jurisdictions, do hereby certify that at the date of this certificate, all currently due and owing taxes and special assessments of any kind assessed against and payable on the land included in this plan, have been paid.

Date Signed: Cathy A. Schmidt, County Clerk (SEAL)

Date Signed: 6/2/14
Tamra K. Seely, City Clerk (SEAL)

Cathy A. Schmidt, County Clerk (SEAL)

Tamra K. Seely, City Clerk (SEAL)

GOVERNING BODY CERTIFICATE:

STATE OF KANSAS)
CITY OF MCPHERSON)

The dedications shown on this plat, if any, are hereby accepted by the Governing Body of the City of McPherson, Kansas, on June 2, 2014.

Thomas A. Brown, Mayor

SEAL

ATTEST:
Tamra K. Seely, City Clerk

REGISTER OF DEEDS CERTIFICATE:

State of Kansas, McPherson County, SS: 2072
This instrument was filed for record on the 2nd day of June, A.D. 2014, at 10:10 o'clock A.M. and recorded in book C on page 40.
Laurie B. Wiersma, Register of Deeds
Stephanie A. Bednarczyk, Deputy

TRANSFER RECORD

Entered on transfer record this 2nd day of June, 2014.

Cathy A. Schmidt, Deputy, County Clerk

CEDAR HILLS REALTY, LLC
3119 QUINTIN RD.
BROOKLYN, N.Y. 11234

COMART DEVELOPMENT, L.L.C.
2300 EAST KANSAS AVE.
MCPHERSON, KS 67460

McPherson Eng. & Land Surveying
1457 N. High Dr.
McPherson, Kansas 67460
(785)479-2354
Drawing Date: 04/03/2014